

Specifications

Nominal Voltage		6 V
Capacity (25°C)	20HR(5.25V)	1 Ah
	10HR(5.25V)	0.93Ah
	1HR(4.80V)	0.65Ah
Dimension	Length	51 ± 1mm (2.01inch)
	Width	42 ± 1mm 1.65inch)
	Height	51 ± 1mm (2.01inch)
	Total Height	57 ± 1mm (2.24inch)
Approx. Weight		0.24kg (0.53lbs) ± 5%
Terminal type		T1
Internal resistance (Fully charged, 25°C)		Approx. 60mΩ
Capacity affected by temperature (20HR)	40°C	102%
	25°C	100%
	0°C	85%
	-15°C	65%
Self-discharge (25°C)	3 month	Remaining Capacity: 91%
	6 month	Remaining Capacity: 82%
	12 month	Remaining Capacity: 65%
Nominal operating temperature		25°C ± 3°C (77°F ± 5°F)
Operating temperature range	Discharge	-15°C ~ 50°C (5°F ~ 122°F)
	Charge	-10°C ~ 50°C (14°F ~ 122°F)
	Storage	-20°C ~ 50°C (-4°F ~ 122°F)
Float charging voltage(25°C)		6.80 to 6.90V Temperature compensation: -9mV/°C
Cyclic charging voltage(25°C)		7.25 to 7.45V Temperature compensation: -15mV/°C
Maximum charging current		0.3A
Terminal material		Copper
Maximum discharge current		15A(5 sec.)
Designed floating life(20°C)		3~5 years

- ◆ Absorbent glass mat technology;
- ◆ Recognized by UL & CE;
- ◆ ABS container.

Constant Current Discharge Characteristics (A, 25°C)

F.V/TIME	5min	10min	15min	30min	60min	2h	3h	4h	5h	10h	20h
4.80V	3.80	2.40	1.90	1.06	0.65	0.355	0.255	0.204	0.173	0.094	0.051
4.95V	3.69	2.33	1.85	1.04	0.64	0.353	0.254	0.203	0.172	0.094	0.051
5.10V	3.53	2.23	1.79	1.01	0.62	0.350	0.252	0.201	0.171	0.094	0.050
5.25V	3.38	2.14	1.73	0.98	0.61	0.345	0.250	0.200	0.170	0.093	0.050
5.40V	3.19	2.02	1.63	0.95	0.59	0.336	0.243	0.194	0.165	0.091	0.049

Constant Power Discharge Characteristics (Watt, 25°C)

F.V/TIME	5min	10min	15min	30min	60min	2h	3h	4h	5h	10h	20h
4.80V	21.2	13.5	10.8	6.07	3.76	2.08	1.51	1.21	1.04	0.57	0.30
4.95V	20.6	13.1	10.6	5.95	3.71	2.07	1.51	1.21	1.03	0.56	0.30
5.10V	19.7	12.6	10.2	5.77	3.61	2.05	1.50	1.20	1.02	0.56	0.30
5.25V	18.9	12.0	9.83	5.63	3.54	2.02	1.49	1.19	1.01	0.56	0.30
5.40V	17.8	11.4	9.31	5.42	3.43	1.97	1.44	1.16	0.98	0.55	0.29

Note: The above characteristics data can be obtained within three charge/discharge cycles.

Dimensions

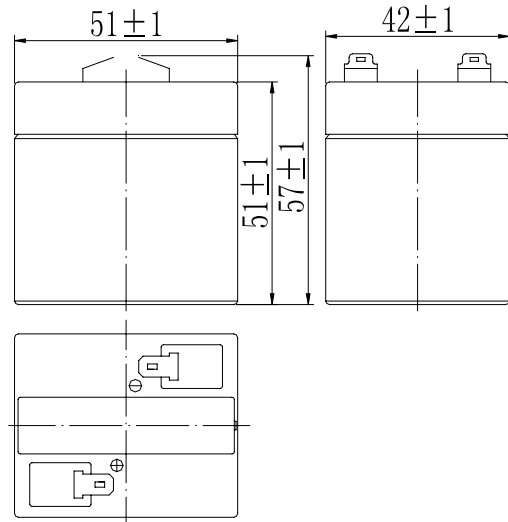

Terminal

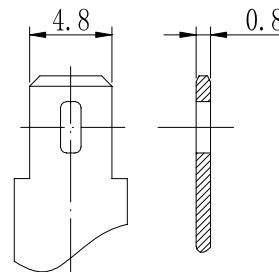

Terminal T1

Discharge Characteristics(25°C)

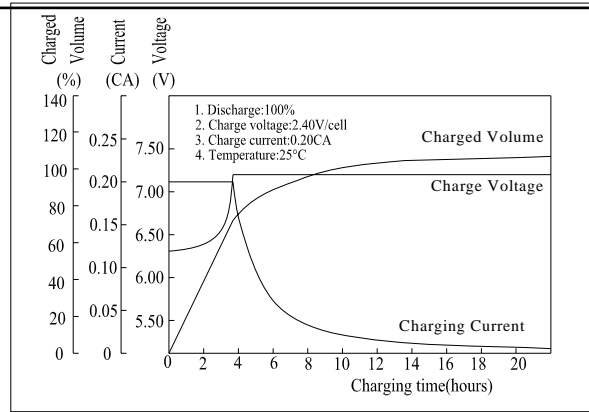
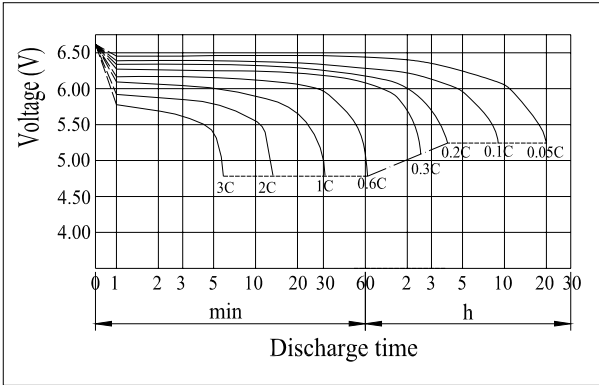

Effect of Temperature on Capacity

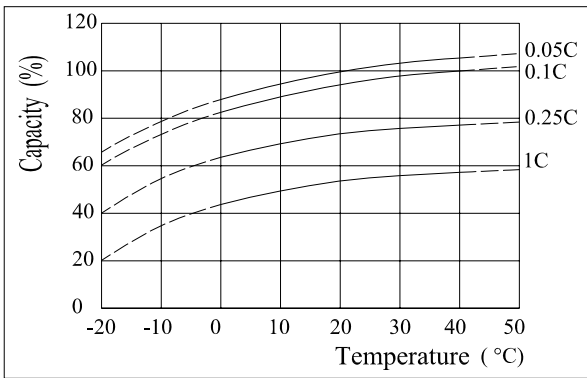

Self-discharge Characteristics

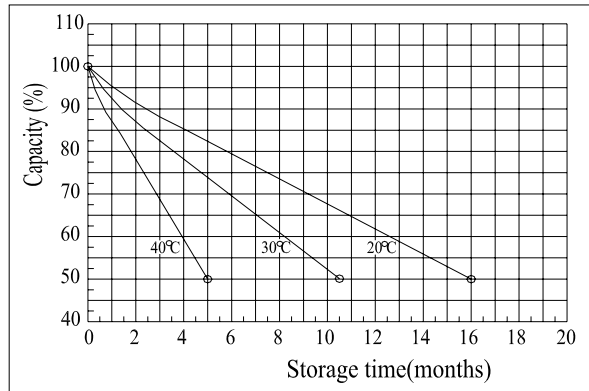

The Relationship for Open Circuit Voltage and Residual Capacity (25°C)

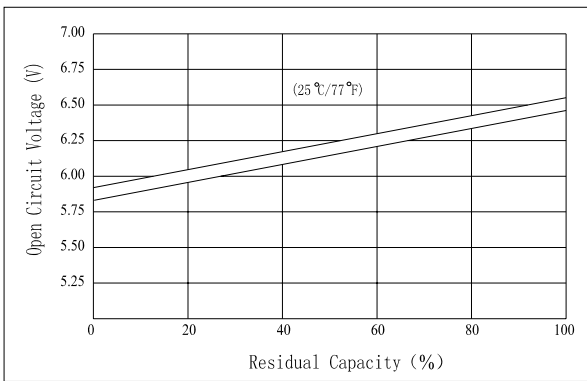

The Relationship for Charging Voltage and Temperature

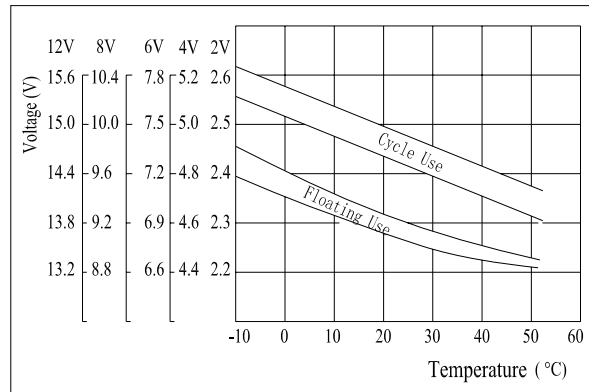

Floating Life on Temperature

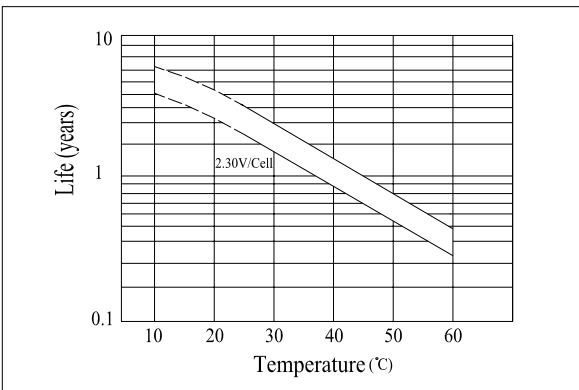

Cycle Life on D.O.D(25°C)

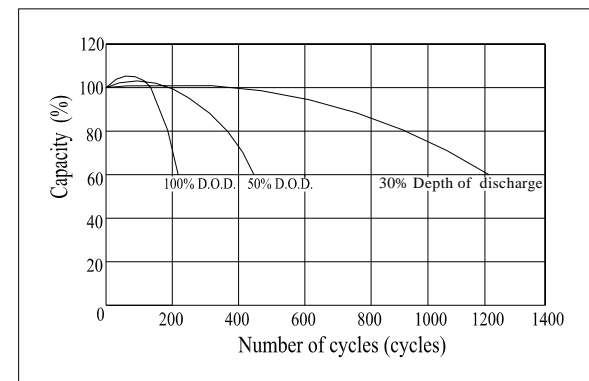

Charging Characteristics(25°C)