

6LF230S-X 12V 230Ah

(Edition Nov 2010)

SUNNY BATT Rechargeable Products
Sealed Lead Acid Battery

General Features

- Positive and negative plates in lead-calcium-tin alloy
- Stable Quality & High Reliability
- Sealed Construction
- Long Service Life
- Maintenance-Free Operation
- Low Pressure Venting System
- Low Self Discharge
- U. L. Component Recognition
- Six months shelf life at 20°C
- Design life 10 years

LF Series

General purpose application

SUNNY BATT LF series are designed for general purpose applications, such as UPS, telecom, electrical utilities.

With 10 years design life, the batteries comply to the most popular international standards, such as IEC896-2, BS6290-4, Eurobat Guide.

The battery container and cover are available both in V0 class flame retardant ABS or HBO ABS plastics.

SUNNY BATT GROUP . has come to obtain wide recognition from customers all over the world. This is not only due to the fact that our products are featured by reliable stability in quality, but also because we attach great importance to our communication with customers and our perfect understanding of customers' requirements as well.



Dimensions and Weight

	<i>SI Units</i>	<i>English Units</i>
Length	520mm	20.5inch
Width	269mm	10.6inch
Height	203mm	8.0inch
Total Height	208mm	8.2inch
Approx. Weight	73.2Kg	161.5lbs

Performance Characteristics

- Nominal Voltage 12V
- Number of cell 6
- Nominal Capacity 77°F(25°C)
 - 10 hour rate (23.0A, 10.8V) 230Ah
 - 5 hour rate (44.6A, 10.5V) 223Ah
 - 1 hour rate (153A, 9.60V) 153Ah
- Internal Resistance
 - Fully Charged battery 77°F(25°C) 2.8mOhms
- Self-Discharge
 - 3% of capacity declined per month at 20°C(average)
- Operating Temperature Range
 - Discharge -20~60°C
 - Charge -10~60°C
 - Storage -20~60°C
- Max. Discharge Current 77°F(25°C) 1100A(5s)
- Short Circuit Current 4300A
- Charge Methods: Constant Voltage Charge 77°F(25°C)
 - Cycle use 14.4-14.7V
 - Maximum charging current 69A
 - Temperature compensation -30mV/°C
- Standby use 13.6-13.8V
 - Temperature compensation -20mV/°C

6LF230S-X 12V 230Ah

Discharge Data

Constant Current Discharge Data (Amperes at 25°C)

End voltage volts/cell			15min	20min	25min	30min	35min	40min	45min	50min	55min	60min	1.5h	2h	2.5h	3h	4h	5h	6h	7h	8h	9h	10h	12h	24h
1.60V			371	307	268	242	216	197	182	170	161	153	111	89.6	76.9	68.5	54.0	45.4	38.0	32.8	28.9	25.8	23.4	20.3	10.4
1.65V			367	304	266	241	215	195	180	168	159	151	110	88.8	76.4	68.2	53.8	45.1	37.9	32.7	28.8	25.7	23.3	20.2	10.4
1.70V			365	302	265	240	214	194	179	167	158	150	109	88.3	76.0	67.8	53.5	44.9	37.7	32.5	28.6	25.6	23.2	20.1	10.3
1.75V			359	298	261	236	211	191	176	165	156	149	108	87.3	75.0	66.8	53.0	44.6	37.5	32.3	28.5	25.5	23.1	20.0	10.3
1.80V			348	290	256	233	208	189	174	164	155	148	107	87.0	74.7	66.5	52.6	44.3	37.2	32.1	28.3	25.4	23.0	19.9	10.2

Constant Power Discharge Data (Watts per cell at 25°C)

End voltage volts/cell			15min	20min	25min	30min	35min	40min	45min	50min	55min	60min	1.5h	2h	2.5h	3h	4h	5h	6h	7h	8h	9h	10h	12h	24h
1.60V			677	573	511	469	423	388	361	335	314	296	213	172	147	131	103	86.7	73.0	63.2	55.9	50.2	45.6	39.5	20.3
1.65V			673	570	507	466	420	386	359	333	312	294	212	171	146	130	103	86.4	72.8	63.0	55.7	50.0	45.4	39.4	20.3
1.70V			666	564	503	462	417	383	357	331	309	291	210	169	145	129	102	86.1	72.5	62.8	55.5	49.8	45.2	39.2	20.2
1.75V			658	558	499	459	415	381	355	328	306	288	208	168	144	128	101	85.8	72.2	62.5	55.2	49.6	45.0	39.0	20.1
1.80V			649	552	494	455	411	378	352	325	302	284	205	166	143	126	100	85.4	71.9	62.2	55.0	49.4	44.9	38.9	20.0

(Note) The above characteristics data are average values obtained within three charge/discharge cycles not the minimum values.

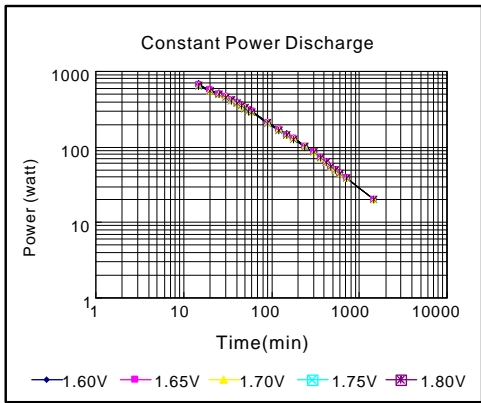
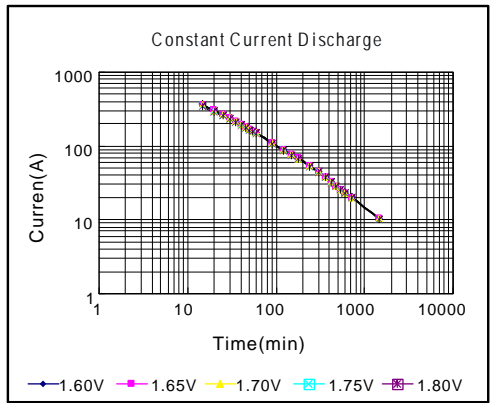
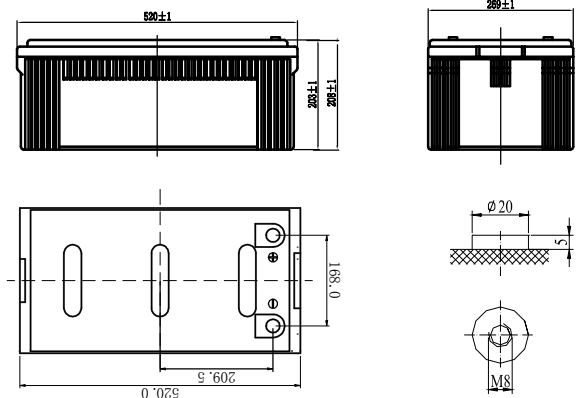

6LF230S-X 12V 230Ah

